



29 Long Meadow, Torriano Avenue, London, NW5 2SU

£475,000

A light and airy two bedroom apartment on the top floor of a small and highly regarded purpose built block.

The apartment is beautifully presented with a open aspect and uninterrupted westerly views.

Accommodation consists of:

- Two double bedrooms
- Separate eat in kitchen
- Reception room
- Bathroom
- Separate WC
- Balcony

Long Meadow is set within the well kept gardens of the Torriano Estate in bustling Kentish Town. Local amenities are excellent and transport links superb. The open spaces of Hampstead Heath and Parliament Hill are on your doorstep and there is a choice of outstanding local schools.

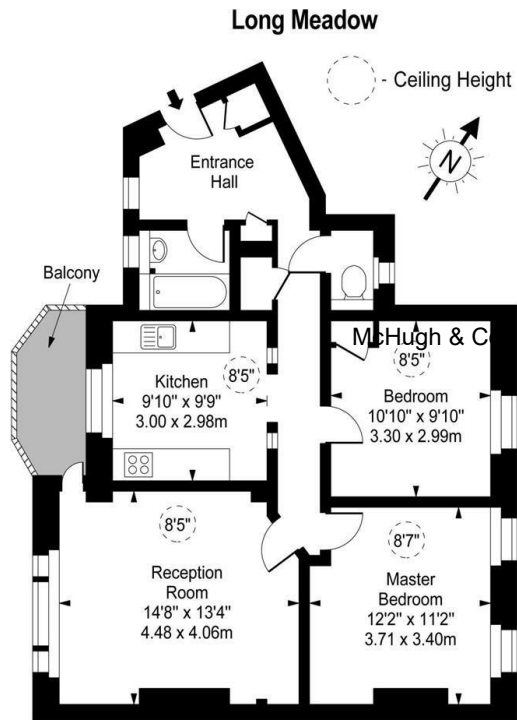

Third Floor
 Gross Internal Area - 745 Sq Ft - 69.21 Sq M
 Approx Gross Internal Area **745 Sq Ft - 69.21 Sq M**
 For Illustration Purposes Only - Not To Scale

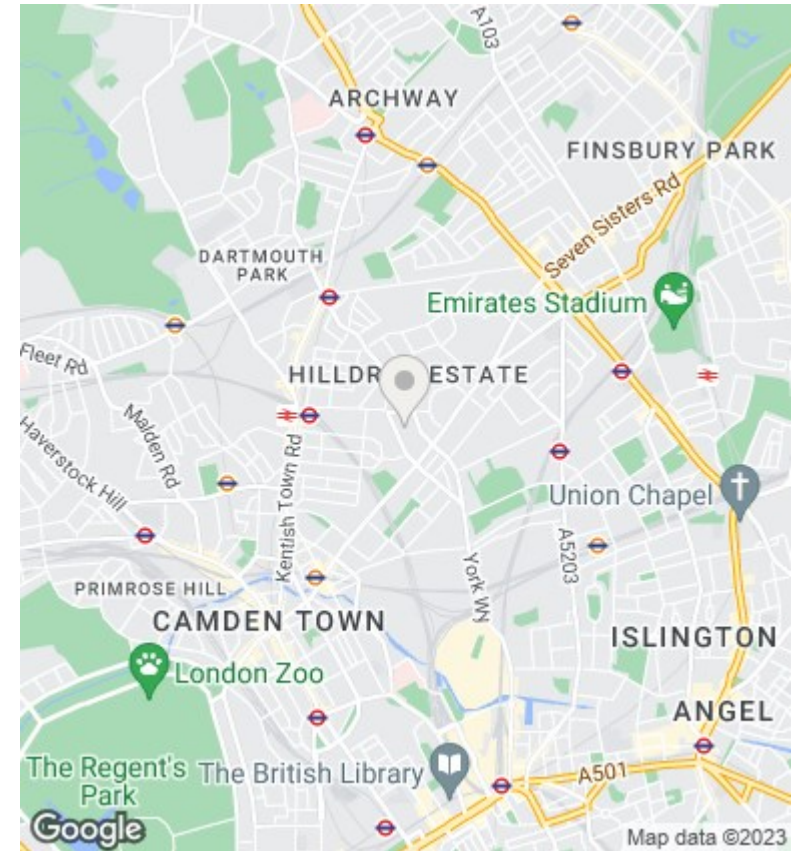

Viewings

Viewings by arrangement only. Call 020 7485 0112 to make an appointment.

Council Tax Band

B

EPC Rating:

D

LEASEHOLD APPROXIMATELY 106 YEARS UNEXPIRED

Energy Efficiency Rating		
	Current	Potential
Very energy efficient - lower running costs		
(92 plus) A		
(81-91) B		81
(69-80) C		
(55-68) D	61	
(39-54) E		
(21-38) F		
(1-20) G		
Not energy efficient - higher running costs		
England & Wales	EU Directive 2002/91/EC	